

Quick Start

Automated High Vacuum Pump-down System with SNAP Vacuum Control

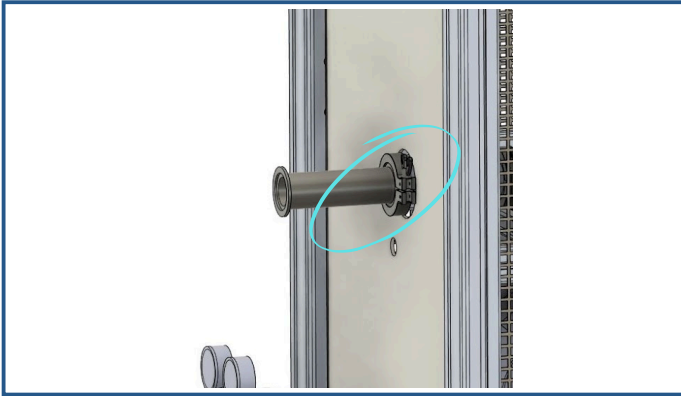

Connect the cart to your system via KF40 connection. *Note: Smooth connections are better for flow.



Connect the Gas regulator on the nitrogen or other inert gas tank to the KF16 venting port on the back of the cart via silicon hose. Or leave open to air.

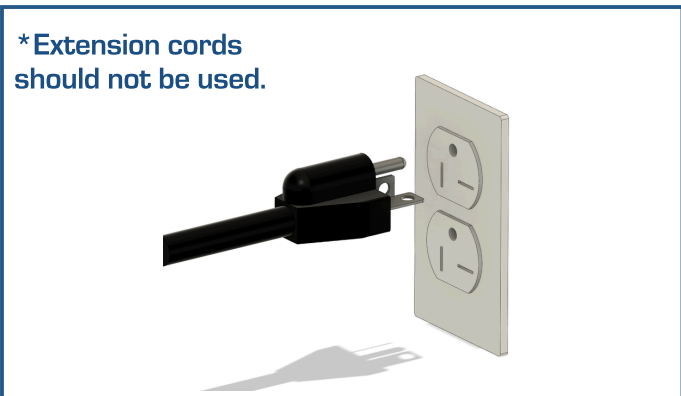

Plug cart into a 20 amp 110V receptacle outlet. *Note: Only the cart can be plugged into the outlet, no other devices.

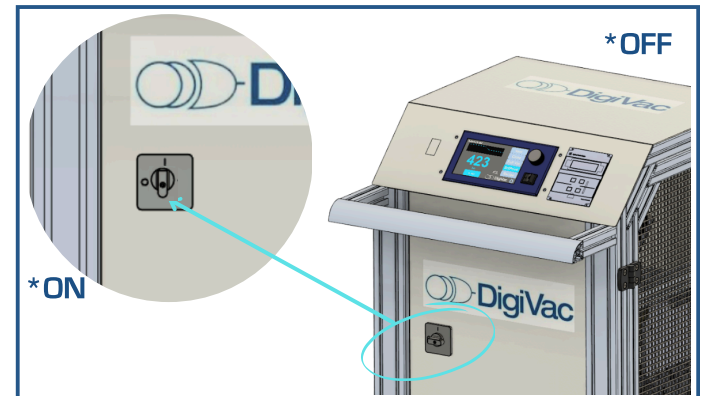

Turn on the power to the cart via the switch on the front.

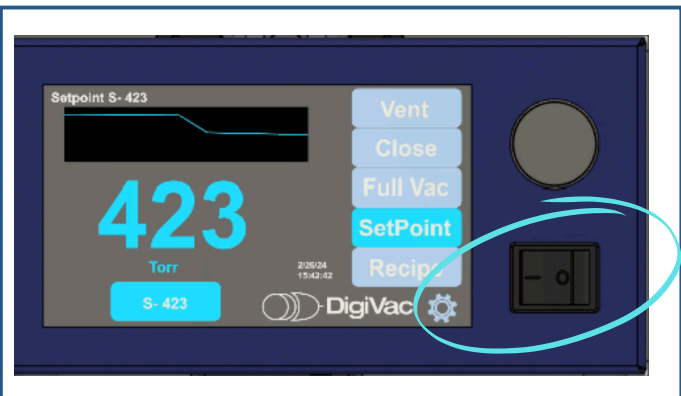

Verify that the SNAP is also switched on.

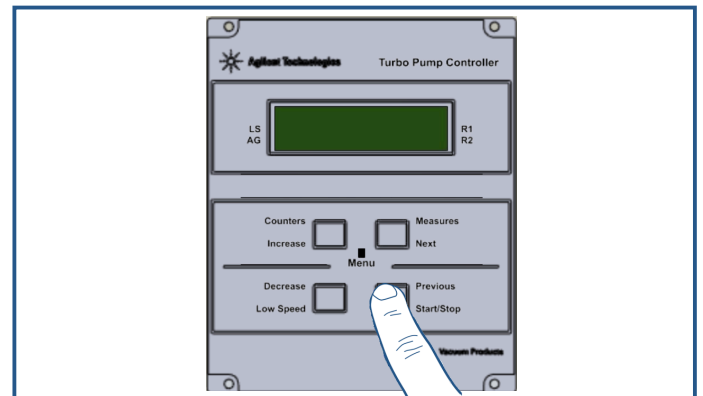

Press "Start" on the Turbo Controller and wait 5 minutes for it to spin up.

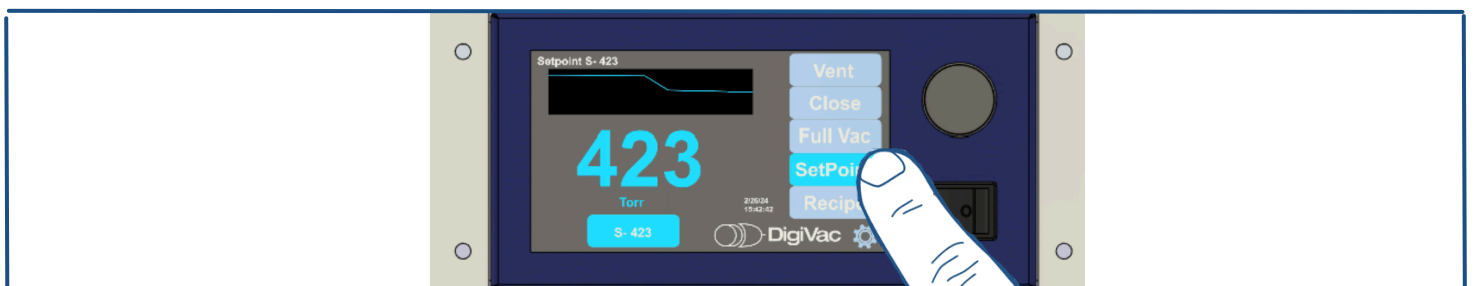

The cart is now ready to control vacuum via the SNAP screen.